



# Centrifugal Sanitary Pumps

## CS - CSX series

### Standard design

Closed coupled hygienic centrifugal pumps with open impellers. CS Series pumps meet the highest requirements of the food, pharmaceutical, chemical and water treatment industries. The pumps are designed to a modular concept, resulting in a large number of models and a massive performance range. When combined with the extremely robust construction, these highly efficient pumps become ideal for any hygienic process system.

Wetted parts in CF-3M 1.4404 / AISI 316L stainless steel, investment cast and electro-chemically polished. Special internal finishes to 0,5 micron Ra are available on request (not on sizes 125 to 150).

Separate IEC standard motor.  
Flow rates up to 500 m<sup>3</sup>/h, heads up to 100 m (10 bar); high performance, with low NPSH values.

The clamp casing and seal design allows quick disassembly for inspection, cleaning and maintenance. It also enables the delivery port to be rotated to any position for easy installation (not on sizes 125 to 150).

For aggressive products and environments, CS pumps can on special request, be manufactured in the following materials:

- Sanicro 28 (1.4563)
- Duplex SAF 2507 (1.4410)
- Hastalloy C276

### Seals:

Mechanical seals with seats to EN 12756, ISO 3069 standards.  
Single internal mechanical seal  
Single external mechanical seal  
Double flushed mechanical seal

### Elastomers (certified to FDA):

- EPDM
- Fluorocarbon (Viton)
- Silicone
- P.T.F.E. (Fep)

Special version equipped with an inducer in the suction port. This device is fitted immediately upstream of the impeller to reduce the NPSH required by the pump.



CS pump with shroud and adjustable feet.

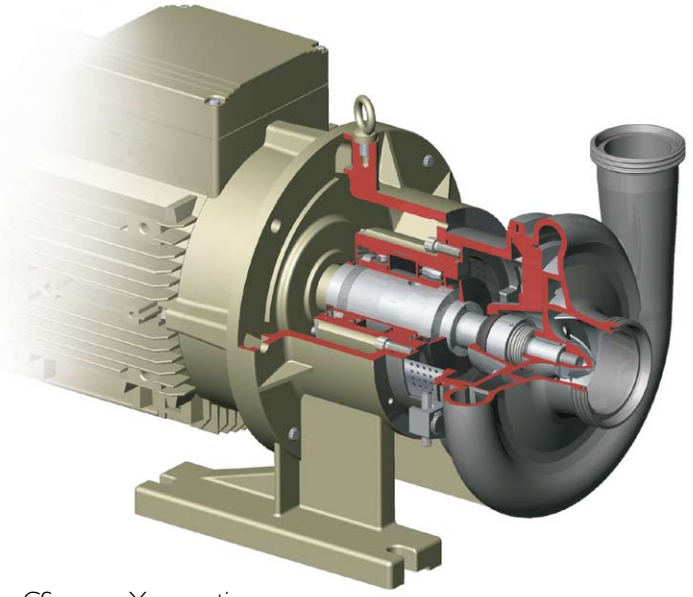

CS pump X execution  
Close coupled centrifugal pumps with separate support frame and grease lubricated bearings, for extremely arduous applications.

### Connections:

DIN - SMS - IDF - BS / RJT - DS - CLAMP and EN 1092-1 PN 16 flanges suitable for all international standards.

## OVERALL DIMENSIONS

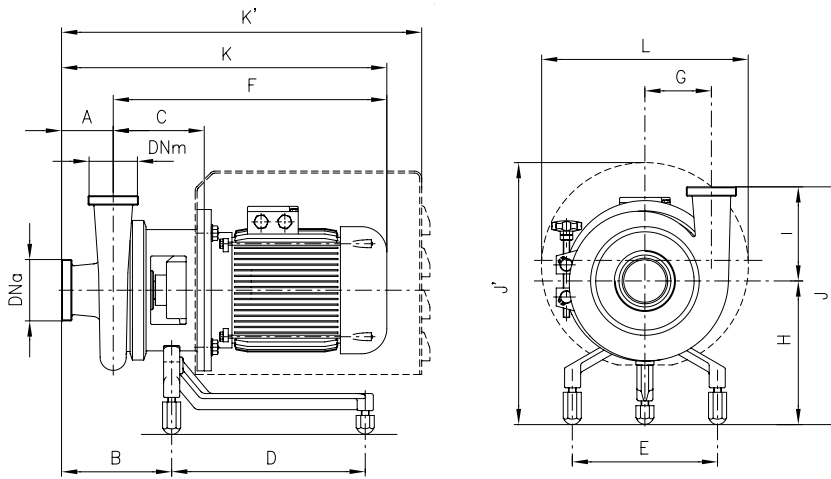

Dimensions not binding - DN = DIN 11851 male threaded connections with standard IEC/EN motors

Pumps	IEC motors size:	DNa	DNm	A	B	C	D	E	F	G	H	K	K'	I	J	J'	L				
CS 25-145	71	32	25	75	144	117	190	178	335	81	158	410	532	145	303	300	239				
	80					359			434			541	340			298					
	90					403			478												
CS 25-175	71	32	25	65	134	117	190	178	335	96	164	410	522	149	313	306	239				
	80					359			424			531	346			298					
	90					403			468												
	100					454	519	619	359		353	330									
	112					466	531														
CS 32-110	71	40	32	70	137	117	190	178	335	65	149	405	527	110	259	291	239				
	80					359			429			536	331			298					
	90					403			473												
CS 32-145	80	40	32	80	167	138	231	225	374	85	208	454	566	145	353	372	298				
	90					418			498												
	100					455	535		619		370	430						330			
	112					467	547														
CS 32-175	80	40	32	80	167	139	231	225	375	95	213	455	567	150	363	385	298				
	90					419			499												
	100					456	536		619		380	435						330			
	112					468	548														
CS 32-210	80	40	32	80	158	139	231	225	375	110	221	455	567	165	386	385	298				
	90					419			499												
	100					456	536		619		403	443						330			
	112					468	548														
CS 32-260	90	50	32	90	184	163	231	225	443	140	221	533	601	172	393	385	298				
	100					480			570			670						410	443	330	
	112					492			582												
CS 40-145	80	50	40	80	168	139	231	225	375	90	208	455	567	133	341	372	298				
	90					418			498												
	100					455	535		619		358	430						330			
	112					467	547														
CS 40-175	80	50	40	80	169	141	231	225	377	95	213	457	569	150	363	377	298				
	90					421			501												
	100					458	538		638		380	435						330			
	112					470	550														
CS 40-210	80	50	40	80	161	141	231	225	377	115	221	457	569	165	386	385	298				
	90					421			501												
	100					458	538		638		403	443						330			
	112					470	550														
CS 40-260	90	50	40	100	194	163	231	225	443	145	221	543	611	172	393	385	298				
	100					480			580			680						410	443	330	
	112					492			592												
CS 50-145	80	65	50	80	170	141	231	225	377	95	208	457	569	145	353	372	298				
	90					421			501												
	100					458	538		638		370	430						330			
	112					470	550														
CS 50-175	80	65	50	80	169	141	231	225	377	100	213	457	569	150	363	377	298				
	90					421			501												
	100					458	538		638		380	435						330			
	112					470	550														
CS 50-210	90	65	50	80	161	141	231	225	421	120	221	501	569	165	386	385	298				
	100					458			538			638						402	443	330	
	112					470			550												
CS 50-260	100	65	50	90	185	165	301	225	481	145	238	571	671	175	413	443	330				
	112								493			583									
CS 65-145	80	80	65	79	173	145	231	225	381	112	208	460	572	145	353	372	298				
	90								425			504									
	100								462			541						642	370	430	330
	112								474			553									
CS 65-175	90	80	65	80	172	144	231	225	424	120	213	504	572	150	363	377	298				
	100					461			541			641						380	435	330	
	112					473	553														
CS 65-210	90	80	65	90	189	168	231	225	448	135	221	538	605	165	386	385	298				
	100					485			575			675						403	443	330	
	112					497			587												
CS 65-260	100	80	65	100	198	168	301	225	484	155	238	584	684	205	443	443	330				
	112								496			596									